

09-67

EDWARD ADLUM

COURSES ON THE RIVER
FROM B UPWARDS TO C

N. 15° E.	22
N. 24° E.	11
N. 16° E.	49
N. 6° E.	23
N. 7° W.	26
N. 2° E.	50
	<hr/>
	181

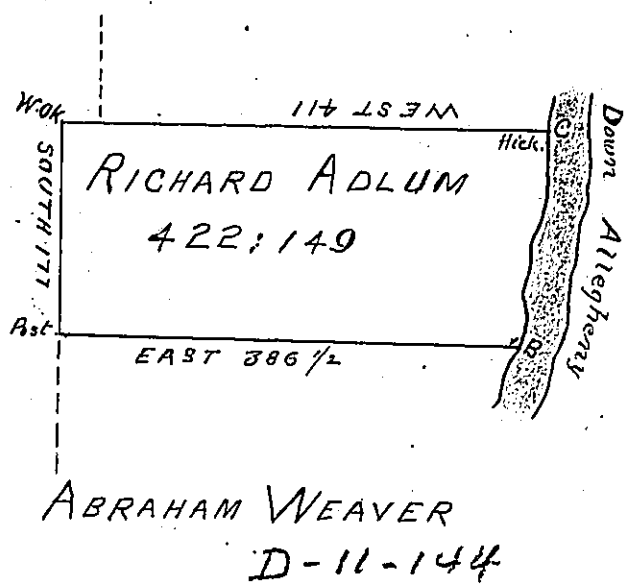

Surveyed on the 23rd day of June 1795 the above described Tract of Land in District No 6, in pursuance of a Warrant to Richard Adlum, dated 20th December 1793 containing Four Hundred Twenty two Acres & 149 Perches and allowance of Six per Cent

*Saml. Nicholson
To Daniel Brodhead Esqr
Surveyor General*

IN TESTIMONY that the above is a copy of the original remaining on file in the Department of Internal Affairs of Pennsylvania, made conformably to an Act of Assembly approved the 16th day of February, 1833, I have hereunto set my Hand and caused the Seal of said Department to be affixed at Harrisburg, this twenty fourth day of August 1903.

Isaac B. Brown
Secretary of Internal Affairs.